

Plus Series Torch & Handle

High capacity, heavy-duty welding handle and cutting attachment

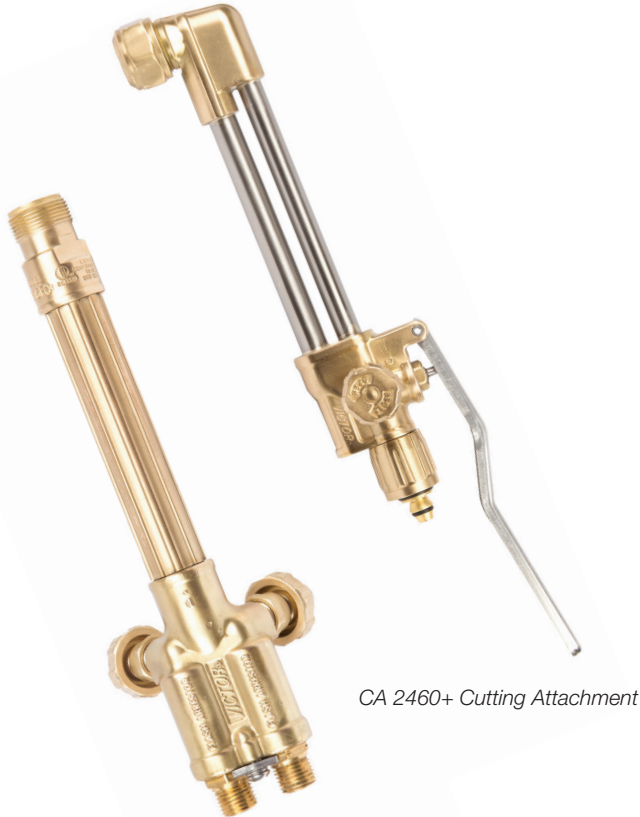

WH 315FC+ welding handle

CA 2460+ Cutting Attachment

The Plus Series WH 315FC+ and CA 2460+, second generation, heavy-duty, high capacity welding handle and cutting attachment improve on the original models from input by talented and insightful craftsmen who use our tools daily.

Vastly improved flow capability allows the WH 315FC+ to replace both the original WH 315FC and the WH H315FC torch handles.

The new CA 2460+ improves flow, connectivity, durability, and reparability for superior ease of use.

- Improved head durability, preheat control valve flow and reduced user fatigue due to improved balance
- Improved access and reparability of mixer with single nut removal
- Superior cutting oxygen valve with improved Feathering/Ease-On control
- No wrench flats on connection nut indicates hand tightening only for safer operation
- Internal connection snap ring prevents coupling nut sliding and exposure to o-rings for reduced damage

Visit esab.com for more information.

Industry

- Ship/Barge Building
- Automotive
- Railcars
- Light Fabrication
- Heavy Fabrication
- Offshore Oil
- Civil Construction
- Repair and Maintenance

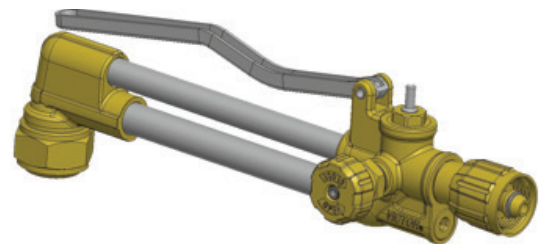

New flip up cutting oxygen lever and ease-on valve

Plus Series Torch & Handle

Specifications	
Gas type	Oxygen and all standard welding, heating and cutting fuel gases including acetylene
Tip compatibility	Series 1 (cutting), W (welding), and MFA/MFN & 55 (heating)
Length	CA 2460+ 10 in. (254 mm) WH 315FC+ 9 in. (228 mm)
Flash Arrestors and Check Valves built in	Yes
Weight	1.5 lbs. (0.6 kg)
Packaging type	Box

Ordering Information		
Description	Part Number	Replaces
CA 2460+ Cutting Attachment, 90 Deg	0381-1928	0381-0816, 0387-0000, 0381-0823
CA 2461+ Cutting Attachment, 75 Deg	0381-1930	0381-0817
CA 2462+ Cutting Attachment, 180 Deg	0381-1932	0381-0818
WH 315FC+ Welding Handle	0382-0093	0382-0316, 0382-0034, 0387-0008
Plus Torch Replacement Pack - WH 315FC+/CA 2460+ 90 deg	0381-1937	0381-1935



ESAB / esab.com

